

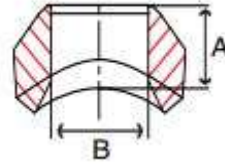

Butt Weld Outlets, Class 3000, Sched 80
Forged 304 Stainless Steel
 Inches / Pounds



Part #	NPS Pipe Size (inch)	For Nominal Pipe Sizes	(A) Hole Center Depth	(B) Inside Diameter	Approximate Weight Each
K380BWO.25-.375X36S	1/4	3/8" thru 36"	0.62	0.36	0.08
K380BWO.375-.5X36S	3/8	1/2" thru 36"	0.75	0.49	0.10
K380BWO.5-.75X36S	1/2	3/4" thru 36"	0.75	0.62	0.10
K380BWO.75-1X36S	3/4	1" thru 36"	0.87	0.82	0.20
K380BWO1-2X36S	1	2" thru 36"	1.06	1.04	0.50
K380BWO1.25-3.5X36S	1-1/4	3-1/2" thru 36"	1.25	1.38	0.80
K380BWO1.5-5X36S	1-1/2	5" thru 36"	1.31	1.61	1.00
K380BWO2-8X36S	2	8" thru 36"	1.50	2.06	1.70

**Forged fitting material conforms to ASTM A182 grade F304/304L*

**Fits Schedule 80 NPS Pipe*

**Manufacturing facility is ISO 9001:2008 Certified*

**Dimensions conform to MSS SP-97*